



# Support Opportunities

---

2025 -2026

Help bring the  
Praespero Center to  
Life!

---

***Presented By:***

**Praespero Group & Praespero Center, LLC**

## **Contact**

Website	<a href="http://praesperogroup.org">praesperogroup.org</a>
Email	<a href="mailto:praesperogroup@gmail.com">praesperogroup@gmail.com</a>
Call/Text	804-396-2878
Address	250 Wylderose Commons, 206, Midlothian, VA 23113

# About Us

The Praespero Center (Pronounced press-pero) is a hybrid family enrichment and therapy facility designed to blend mission-driven community impact with sustainable business operations.

The Center operates through two complementary entities, **Praespero Center LLC (for-profit)** and **Praespero Group (501(c)(3) nonprofit)**, working together to deliver accessible therapy, enrichment, and educational programs for children and families in Chesterfield County.

This hybrid model ensures that revenue-generating services sustain operations while nonprofit funding expands access for underserved families and community programs.



## MISSION

We will provide affordable, fully inclusive enrichment and therapy services—including sensory integration, speech, art, music, and social-emotional learning—to children, particularly those with developmental, learning, or behavioral challenges and those underserved in our community.

Our center will offer a space where every child's strengths are celebrated, and families experience connection, support, and meaningful progress together.



## VISION

We envision a community where all children, regardless of developmental or behavioral differences, have equitable access to the therapies and opportunities that build lifelong confidence, creativity, and independence.

By eliminating barriers to care and fostering partnerships with schools, healthcare providers, and local organizations, the Praespero Center will spark a generational impact that uplifts families and strengthens communities.



## LOCATION



# Community Need and Impact

*\$1 Invested in early intervention saves \$4 - \$9 in future costs.*



Chesterfield County is home to more than **61,000 children ages 4–12**, representing a significant portion of families in need of developmental, behavioral, and educational support. When expanded to include all children and adolescents under 18, the number rises to 88,500, highlighting the scale of need across the community.

Yet, despite the size and growth of this population, families face barriers to timely, inclusive, and comprehensive services. Current systems, including schools, private clinics, and county programs, do not adequately meet the demand, leaving families without accessible, coordinated care.

**61,000**

Children age 4-12

**17%**

Children who have developmental disabilities, including ADHD, speech delays, or learning disorders

**1 in 36**

Children diagnosed with Autism Spectrum Disorder

## Waitlist Challenges

**6 months**

Waitlist for ABA Therapy

**11 months**

Waitlist for Occupational Therapy

**42 months**

Waitlist for Speech Therapy

## Increased Likelihood of Suspension or Expulsion

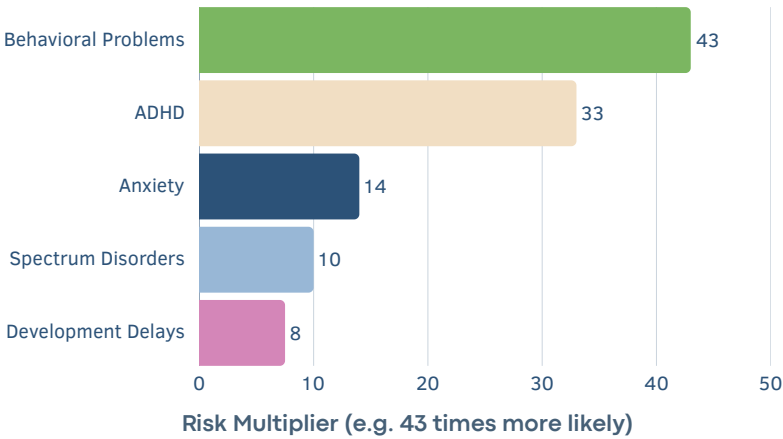

## Economic & Social Impact



Parents are forced to reduce work hours or leave the workforce to manage appointments.



Increased long-term educational expenses when children miss early intervention opportunities.



Future healthcare and social service costs grow due to untreated developmental and behavioral issues.

# Help Bring the Praespero Center to Life

A place where children and families grow, learn, and flourish together.

The Praespero Group and the Praespero Center, LLC. are working hand in hand to bring a first-of-its-kind space to life, one that blends therapy, enrichment, and community connection under one roof.

## Praespero Group

The Praespero Group, a 501(c)(3) nonprofit organization, leads the effort to fund and build the Center — ensuring accessibility, inclusion, and opportunity for children and families of all abilities. Through grants, community giving, and donor support, the nonprofit is focused on creating a space where every child can grow and every family feels supported.

## The Praespero Center

The Praespero Center LLC, a mission-driven operating partner, will lease the space from the nonprofit and bring it to life day-to-day through therapy programs, enrichment classes, memberships, and family events. Together, they form a sustainable model — one that reinvests directly into the community and ensures long-term impact.

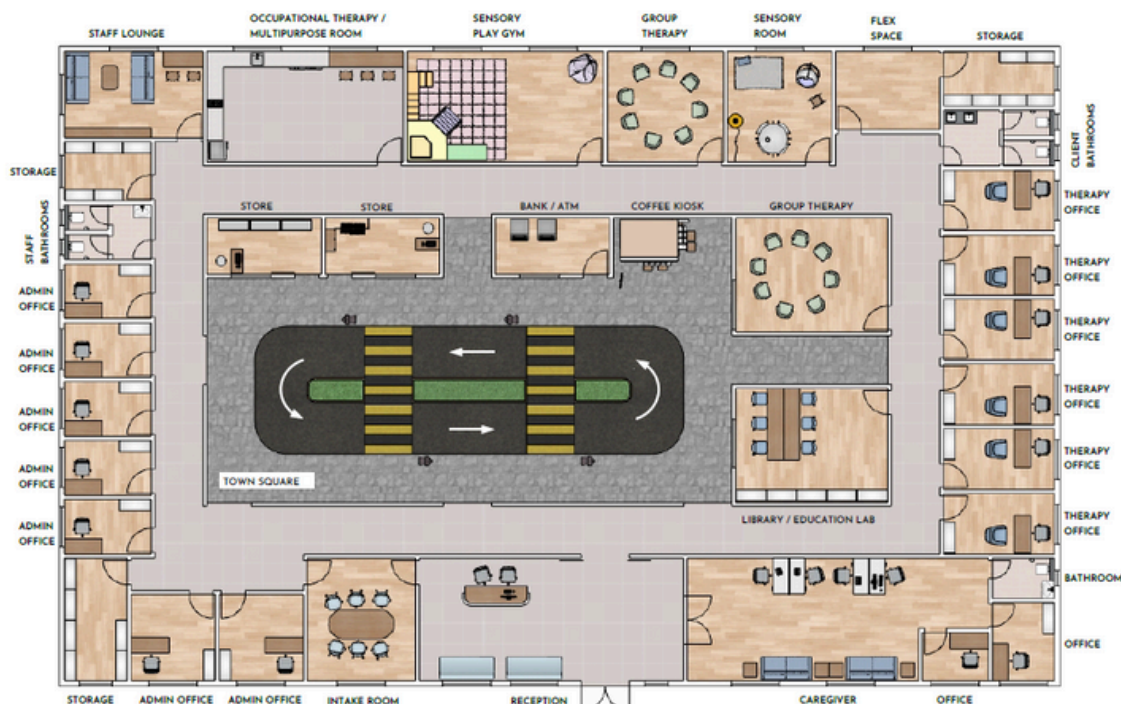

We have many opportunities for support — from helping fund the facility build-out to dedicating a bloom on our donor wall — each one helping to grow this vision into reality.

# Support Opportunities

## Praespero Group (Nonprofit – 501(c)(3))

Praespero Group, a nonprofit organization, is leading the effort to bring this facility to life through community donations, grants, and charitable gifts. All donations are tax-deductible and go directly toward building out and equipping the Center, creating an accessible, inclusive space where children and families can learn, grow, and thrive.

### Roots of Promise - \$50,000 +

Your generosity lays the foundation for the Center's mission and brings major spaces like the Sensory Gym, Sensory Room, Caregiver Lounge, or Town Center to life.

**Includes:** Naming on a major space, featured recognition in donor materials, and a cluster of large blooms at the heart of the Bloom Wall.

### Branches of Hope - \$25,000 + \$49,999

You help expand our reach and provide the stability that allows families and programs to flourish.

**Includes:** Plaque on a Group Therapy Rooms or Multipurpose Room Library, recognition on the Bloom Wall, and acknowledgment in annual donor listings.

### Garden of Growth - \$10,000 + \$24,999

Your support nurtures new programs, resources, and connections that help children and families thrive.

**Includes:** Plaque on a Education Lab or individual therapy room, recognition on the Bloom Wall, and acknowledgment in annual donor listings.

Donations are recognized through gratitude signage and listings — not advertising or promotions — to preserve full IRS deductibility.



# Support Opportunities

## Praespero Group (Nonprofit – 501(c)(3))

### Bloom Wall

The **Praespero Bloom Wall** is a vibrant, ever-growing art installation that honors those who help children and families flourish. Each bloom represents a donor—a family, friend, or organization—whose generosity helps the Center grow.

**Donors may dedicate their bloom to:**

- Celebrate a loved one or family member
- Honor a child, therapist, or teacher who inspired them
- Commemorate a milestone or memory
- Share a message of hope for future families

Each bloom becomes part of a collective story—a garden of gratitude that grows alongside the families we serve.

Dedication Type	Cost	Display Size	Includes	Character Limit	Example
Seeds of Hope	\$250	Name on Base of Wall	Engraved Name Only	Up to <b>35 characters</b>	<i>The Johnson Family</i>
Sprouting Leaf	\$500	3-Inch Leaf	Engraved Name	Up to <b>60 characters</b>	<i>In Honor of Emily Grace, Our Sunshine</i>
Growing Bloom	\$1,000	5-Inch Flower	Engraved Name & Dedication	Up to <b>75 characters</b>	<i>In Loving Memory of Grandma Rose – Forever in Our Hearts</i>
Flourishing Flower	\$2,000	6–8 Inch Flower	Engraved Name, Dedication & Photo	Up to <b>100 characters</b> + photo upload	<i>For the Smith Family – Planting Seeds of Hope for Every Child</i>

Donations are recognized through gratitude signage and listings — not advertising or promotions — to preserve full IRS deductibility.

# Support Opportunities

## Praespero Center (For-Profit)

Once built, **Praespero Center LLC**, a mission-driven for-profit, will operate the daily programs, therapy, and enrichment services within the space—ensuring long-term sustainability and growth.

Sponsorships through the Center provide visibility and brand connection with families and the community while supporting our mission to create a space where every child and family can thrive. These are marketing partnerships, not charitable donations, and offer businesses the opportunity to align their brand with positive community impact.

### Community Life Town Partner

We are seeking community partners such as banks, grocery stores, medical centers, cafés, salons, and other local businesses to help bring the Town Center to life by outfitting and naming the buildings within our replica community.

Partnerships offer a unique opportunity to:

- Showcase your brand within an immersive learning environment
- Engage directly with families, therapists, and the community
- Demonstrate your company's commitment to inclusion and local impact

Each 5-year sponsorship includes naming rights, customized storefront design, and year-round visibility as part of the Center's educational experience.

Sponsorships range from **\$25,000 to \$200,000** and are renewable at the end of the term.

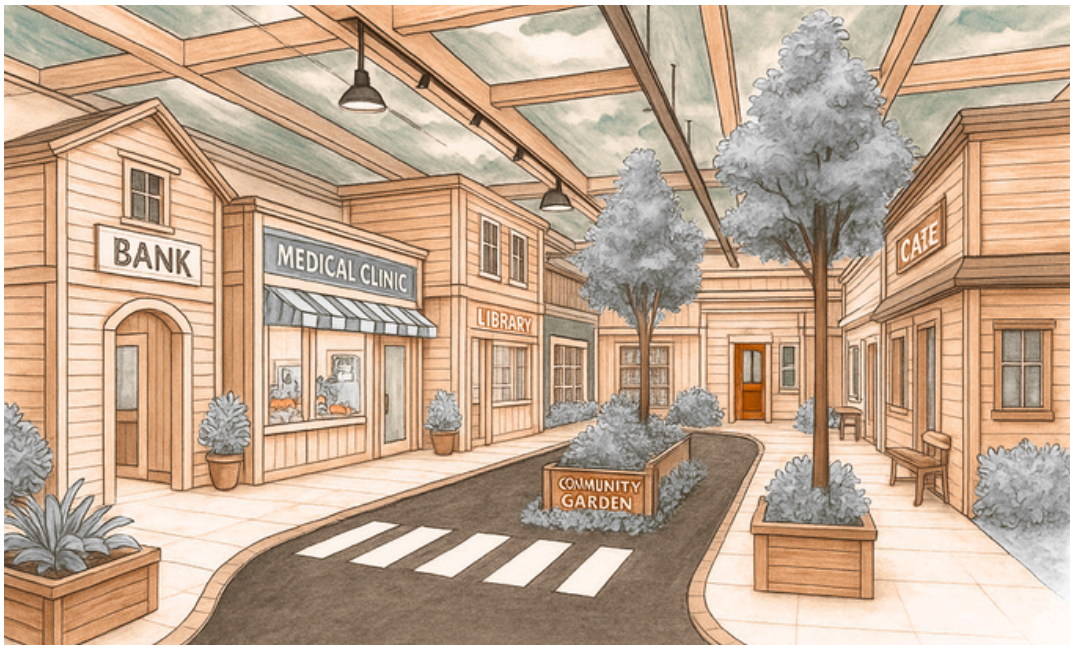

Please note all Sponsorships are structured as marketing partnerships and are not tax-deductible charitable donations.

# Support Opportunities

## Praespero Center (For-Profit)

### Caregiver Monthly Night Out Sponsorship

Each month, the Praespero Center hosts a Caregiver Night Out — an evening designed to give caregivers a chance to relax, recharge, and connect while their children enjoy supervised activities at the Center.

Sponsorship includes:

- Naming recognition in the event title (e.g., “The ABC Bank Caregiver Night Out”)
- Logo placement on all event promotions, website listings, and social media posts
- On-site signage and opportunity to provide branded giveaways or host a small table at the event

**12 Month Sponsorship - \$8,000**

**6 Month Sponsorship - \$4,000**

### Program Sponsor

Praespero Center’s therapy and enrichment programs run year-round — from sensory play and art exploration to music, movement, cooking, and life-skills classes. These programs create joyful, hands-on learning experiences for children of all abilities while supporting family growth and connection.

Sponsorship includes:

- Naming recognition in the program title (e.g., “Music & Movement presented by XYZ Health”)
- Logo placement on class schedules, flyers, website, and social media posts promoting the program
- On-site signage in program rooms and inclusion in family communications
- Recognition during related Center events and open houses
- Optional opportunity to visit or host a class activity in partnership with staff

**Investment: \$7,500 annually or \$2,500 per session cycle**

(Pricing may vary based on program type and duration.)

**Please note all Sponsorships are structured as marketing partnerships and are not tax-deductible charitable donations.**



# Support Opportunities

## Praespero Center (For-Profit)

### Other Partnerships

In addition to storefront and program sponsorships, Praespero Center welcomes custom partnership contributions to help sustain and enhance our family and community programs.

Businesses can participate by providing:

- Cash partnerships to fund program materials, events, or facility needs
- In-kind contributions such as supplies, furniture, professional services, or equipment

**All contributions are structured as marketing partnerships, offering visibility, brand alignment, and acknowledgment based on value and level of support.**

**Please note all Sponsorships are structured as marketing partnerships and are not tax-deductible charitable donations.**

# To learn more about our project scan below!



## Contact

<b>Website</b>	<a href="http://praesperogroup.org">praesperogroup.org</a>
<b>Email</b>	<a href="mailto:praesperogroup@gmail.com">praesperogroup@gmail.com</a>
<b>Call/Text</b>	804-396-2878
<b>Address</b>	250 Wylderose Commons, 206 Midlothian, VA 23113